



GUIDE TO SETTING UP A DATA INTERCHANGE ENVIRONMENT

EXPLAINS HOW TO SET UP A STANDARD IMPLEMENTATION OF DATA INTERCHANGE

Version: 1.04



Published: Friday, 2 September 2016



SETTING UP A STANDARD DATA INTERCHANGE ENVIRONMENT

AEMO recommends setting up your first Data Interchange (DI) environment in pre-production. Once you have a successful pre-production installation (used for testing), you can repeat the installation in production to receive live market data. Be careful to always keep the pre-production and production data entirely separate.

A standard DI environment is a single data feed, from one Participant ID folders on the participant file server, to a single participant database. For example, you can have your pre-production environment connected to the participant file server pre-production environment and your production environment connected to the participant file server production environment.

AEMO's production and pre-production environments are independently operated, so the set of components shown in [Figure 1 on the next page](#) are duplicated for production and pre-production. To set up a standard Data Interchange environment, follow the steps in [Table 1 on page 4](#).

For help upgrading an existing DI environment, see [Guide to Upgrading Data Interchange on AEMO's website](#).



Figure 1 standard Data Interchange implementation

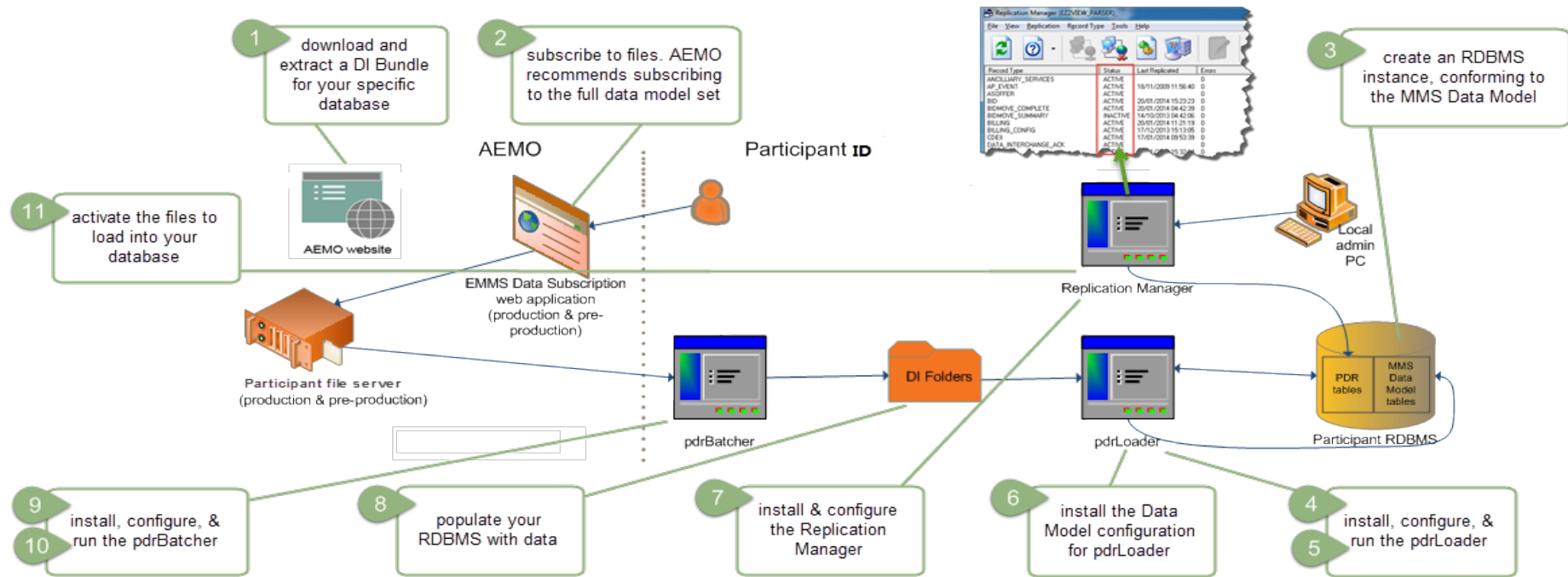

Under no circumstance point your pre-production environment to the AEMO production environment or vice versa. All participants are encouraged to use the pre-production environment to test implementation and to train their participant users, before attempting any changes or operations on the production systems.



Table 1 Steps to set up a standard Data Interchange environment

Step	Task	Component	Reference (contained in the DI bundle)
1	Download and extract a DI bundle for your specific database (Oracle or SQL Server).	Data Interchange Bundle	AEMO's website or Participant file server.
2	Create an RDBMS instance, conforming to the MMS Data Model: <ol style="list-style-type: none"> 1. Install the RDBMS. 2. Install the latest MMS Data Model structure (target tables). Do not make any changes to the MMS Data Model structure. 	Electricity Data Model (MMSDM) Gas Data Model (GASDM)	MMS Data Model GUI Installer Guide MMS Data Model Report MMS Data Model Table to File Report
3	Set up Data Subscription Services: <ul style="list-style-type: none"> • Subscribe to files. AEMO recommends subscribing to the full data model set. 	Data Subscription web application	Web portal: https://portal.preprod.nemnet.net.au/Portal/portal.aspx Data Subscription Services User Interface Guide
4	Install and configure the Participant Data Replication Loader (pdrLoader)	pdrLoader	Participant Data Replication Loader GUI Installer Guide
5	Run the pdrLoader application: <ul style="list-style-type: none"> • In Windows, double-click pdrLoader.bat file in the Lib folder or start the Windows service. • In unix-like environments, execute the pdrLoader.sh file in the Lib folder. 	pdrLoader	Participant Data Replication Loader User Guide
6	Copy the Data Model configuration for pdrLoader.	pdrLoaderConfiguration	MMS Data Model pdrLoader Configuration Implementation Note
7	Install and configure the Replication Manager: <ol style="list-style-type: none"> 1. Extract and install the Replication Manager software on a local PC running Microsoft Windows to monitor and control the operation of the pdrLoader. 2. Set the tables you want to populate to Active. 	Replication Manager	Replication Manager User Guide.



Step	Task	Component	Reference (contained in the DI bundle)
8	Activate the files to load into your database.	Replication Manager	Replication Manager User Guide
9	Populate your database with data: <ol style="list-style-type: none">1. If you don't have access to AEMO's systems yet and you want to test your implementation, you can find CSV files on AEMO's website.2. Load the baseline data to the your pdrLoader folder. (baseline data excludes historical data).3. Load the optional historical data.	pdrLoader input folder	AEMO's website: Electricity Data and Gas Market Data Baseline data is available from the participant file server \MarketData\Baseline Historical data is available on CD from AEMO's information and support hub, phone: 1300 AEMO 00 (1300 236 600), option 2 email: supporthub@aemo.com.au Concise Guide to Data Interchange/Components
10	Install the Participant Data Replication Batcher (pdrBatcher).	pdrBatcher	Participant Data Replication Batcher User Guide
11	Run the pdrBatcher application: <ul style="list-style-type: none">• In Windows, double-click pdrBatcher.bat file in the Lib folder or start the Windows service.• In unix-like environments, execute the pdrBatcher.sh file in the Lib folder.	pdrBatcher	Participant Data Replication Batcher User Guide